



अविण्य NIRMAN JAYRAJ APT. CHS. LTD.

MAHARERA NO P99000078614



A Project by



SHREE BALAJI
ENTERPRISES
BUILDERS & DEVELOPERS

Site Office :

Shop No. 312, Vrindavan Complex CHS Ltd., Om Nagar, Diwanman, Vasai (W)



अविष्णु NIRMAN
JAYRAJ APT. CHS. LTD.
MAHARERA NO P99000078614



EXTERNAL AMENITIES

- Earthquake Resistant Mixan RCC Framed Structure
- Spacious & Decorative Entrance lobby
- External Paint Finish with Acrylic Paint
- Hi-speed Branded Elevators
- External plumbing using Branded PVC
- Standby power backup for lift, lights in common area and staircase
- 24 hours CCTV Surveillance

INTERNAL AMENITIES

- Well ventilated apartments
- Vitrified (4x2) tiles flooring in Living Room, Kitchen and Passage.
- Vitrified (4x2) tiles flooring in Bed Room
- Coates Kitchen Platform with S.S. Sink
- Coates Service Kitchen Platform
- Coates on all windows Seals
- Full height tiles in Kitchen
- Modular Kitchen
- Dado of (2x1) tiles in Toilets
- Covered door frames with laminated door panels
- Open sliding window
- Concealed copper wiring with adequate electrical points & modular switches with MCB circuit breaker
- Concealed plumbing
- Branded sanitaryware and quality C.P. fittings
- For internal walls Oil-bond Royale Paint finish
- Video door Security System.

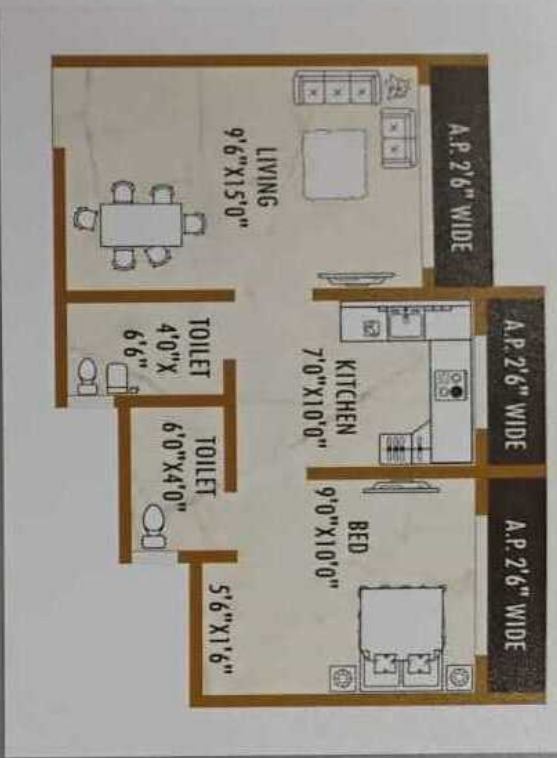

1 BHK



* Image is for illustration purpose only

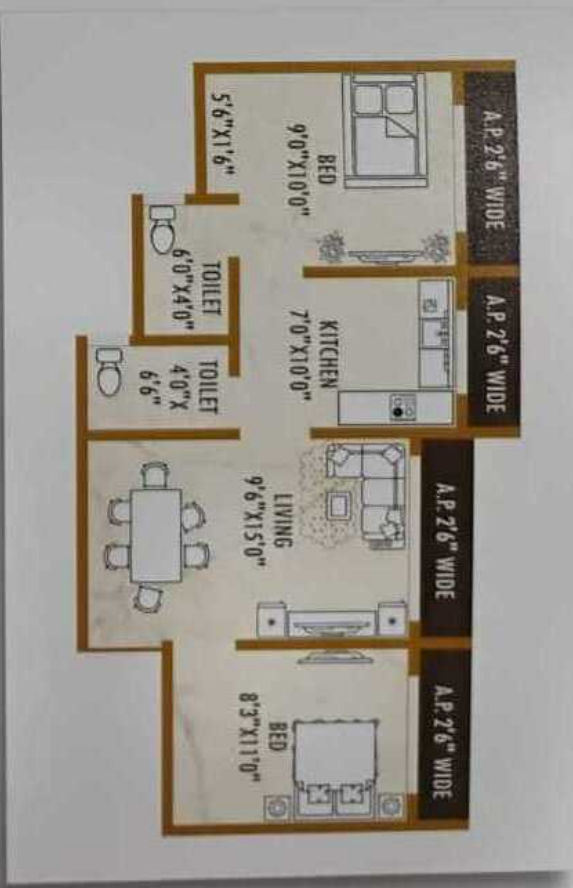

2 BHK



* Image is for illustration purpose only

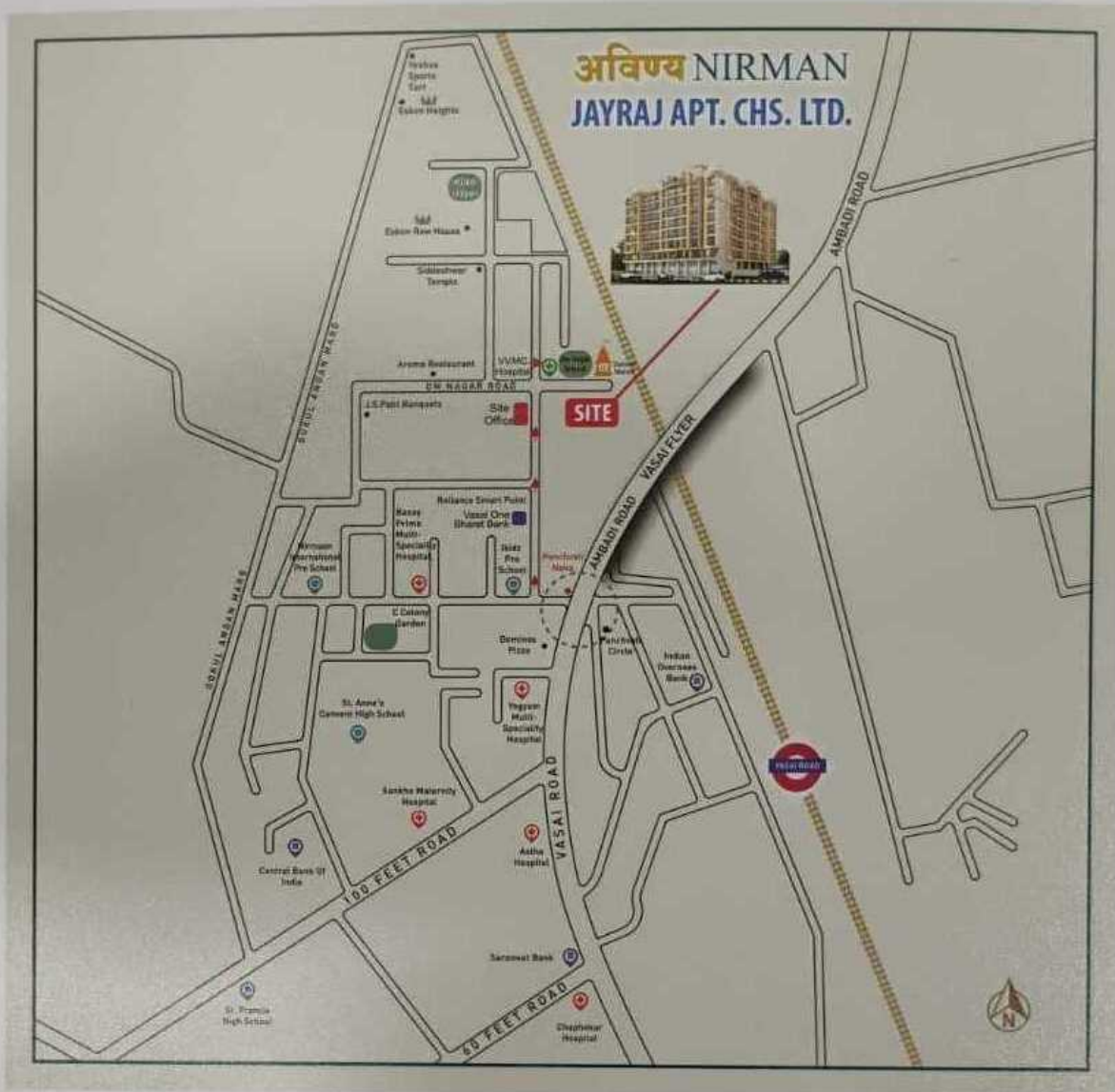

A Project by



SHREE BALAJI
ENTERPRISES
BUILDERS & DEVELOPERS

Office : 101, Navkar CHS, Patankar Park, Nallasopara, Tal. Vasai, Dist. Palghar - 401 203.
Mobile : 98223 75915 / 97660 92276

Architect
M/s. A. P. Associates
Palghar

Legal Advisor
Nilesh Gharat
Nallasopara

RCC Consultant
CON-ARCH India
Consulting Structural
Engineer, Mumbai

DISCLAIMER :

All layouts, locations, plans, specification, designs, elevations, features amenities, services, product/equip type and brand mentioned are indicative of the kind of development proposed in this Project and its finality is subject to the approval of the respective authorities or as required by the Promoter/Developer in the interest of continuing improvement, without prior notice or obligation. The picture/images and perspective views of the premises/building/layout are an artist's impression of the development and for representational purposes only and are not a part of actual deliverables. The details, pictures and images contained in the leaflets, brochures or any other printed material does not constitute an offer and/or contract of any type between the Promoter/Developer and the Purchaser.

MahaRERA Registration No. P99000078614 available on the website: <http://maharera.mahaonline.gov.in>