

# VNM PEDAL LITE

## Quick Guide

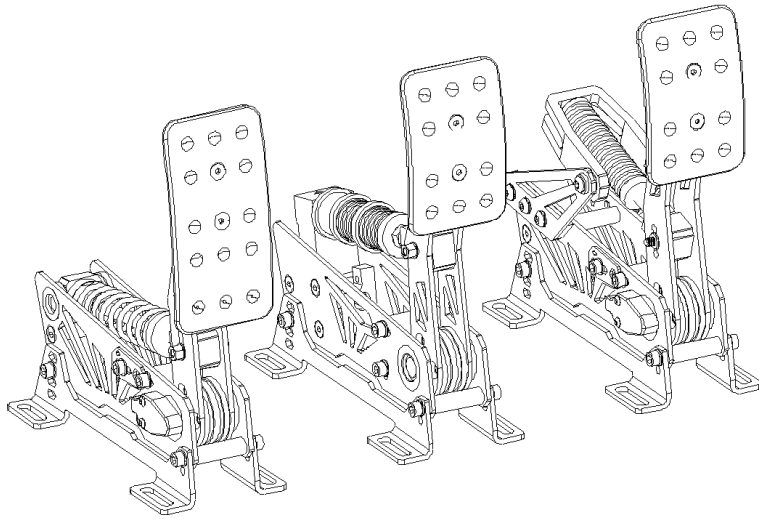

## Content

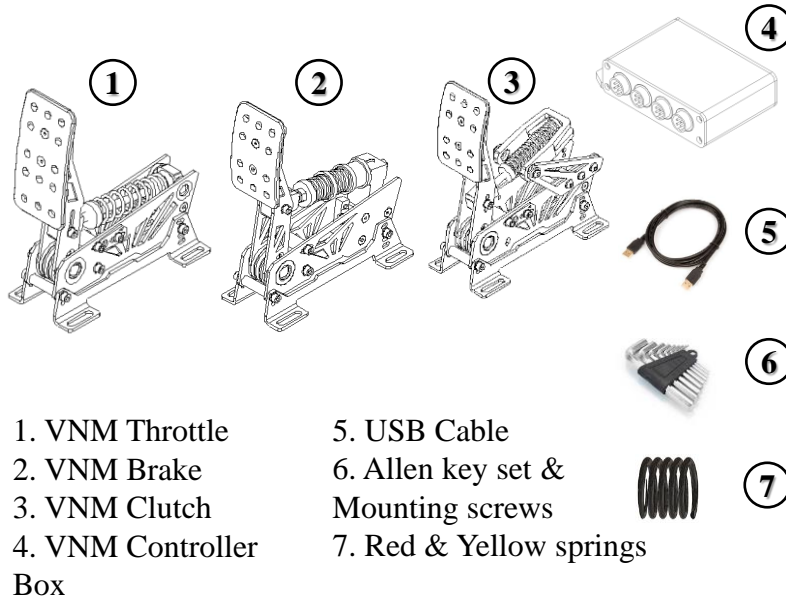

## Connection

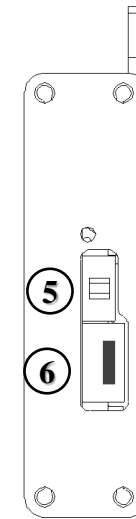

✓ On the left side of the VNM Controller Box is:

1. Handbrake 3. Brake  
2. Throttle 4. Clutch  
Plug in the GX12 ports for signal connection.

✓ On the right side of the VNM Controller Box is:  
5. Switch **DFU/Game Mode**  
Slide left side to select **DFU Mode** or right side to select **Game Mode**.

6. Plug in USB cable to connect to PC.

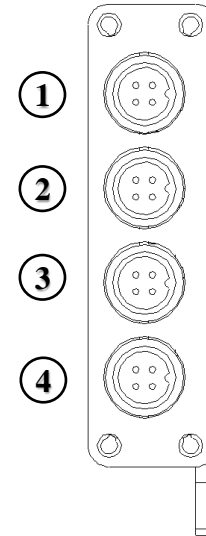

## Adjust Pedal

### 1. Adjust the height of the Pedal face

Loosen the 4 the hex bolts on the sides behind the pedal face, choose a suitable pedal height, then tighten.

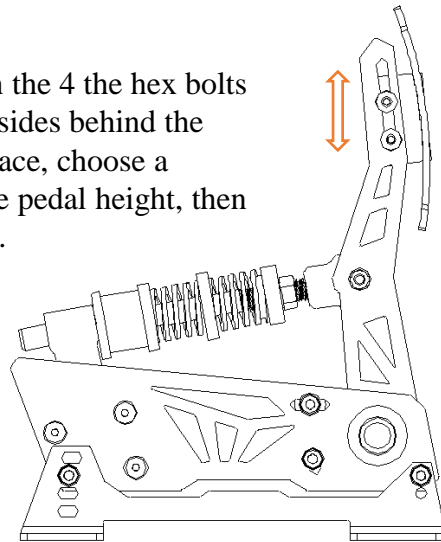

### 2. Adjust the Pedal tilt angle

✓ Here we give 6 options so you can change the angle of the pedal to your liking.

✓ Remove the 2 hex bolts on the sides, then choose the angle that suits you and tighten them with the hex bolts.

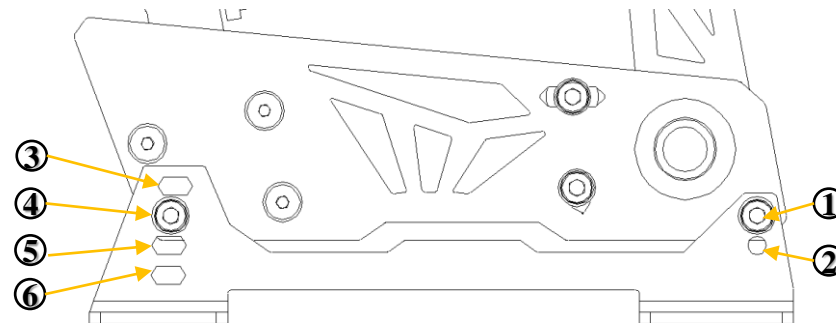

### 3. Adjust the Pedal Force

✓ Adjust the spring preload so that the pedal force is right for your foot

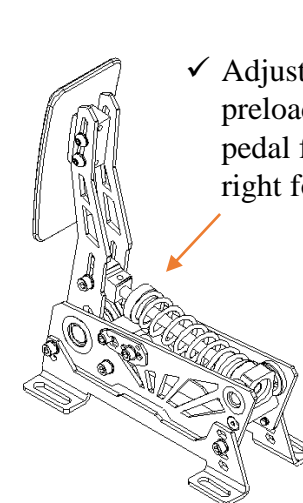

✓ In addition, you can also change the force by adjusting the position of the screw here

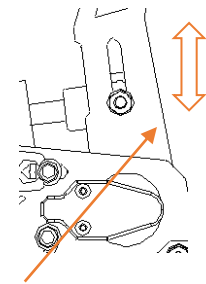

## 4. Adjust the Pedal Journeys

- ✓ Loosen the 2 hex bolts on the sides, adjust 2 blue bumpstops to change pedal stroke

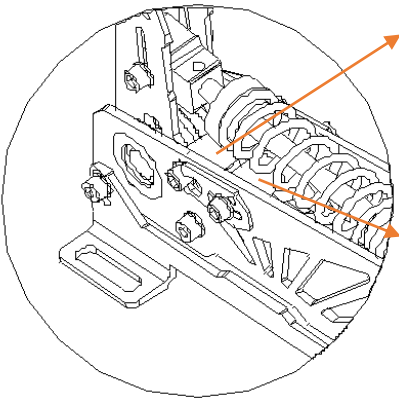

- Blue Bumpstop 1:** Move blue bumpstop to change pedal stroke limit.
- Blue Bumpstop 2:** Adjust the inclination of the pedal face (pedal stroke start point)

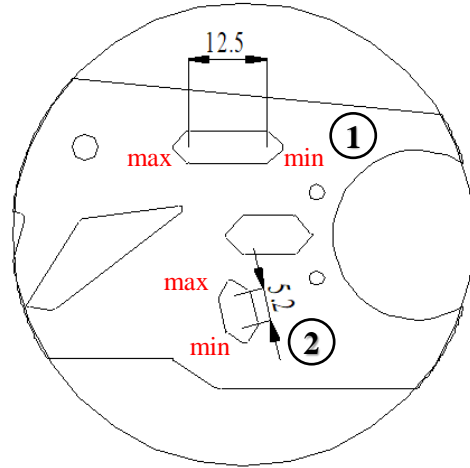

- ✓ Adjusting the Blue Bumpstop 1

Step 1: Remove spring assembly.

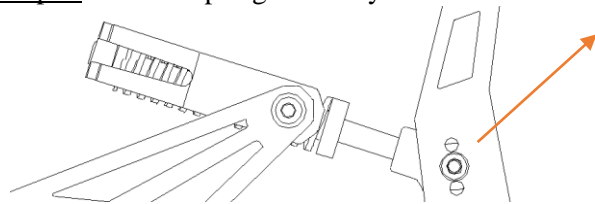

Remove bolts then  
remove spring assembly

Step 2: Loosen the hex bolts 1 & 2 on the sides then choose the location of the blue bumpstop that works for you and tighten the hex bolts 2 you just loosened.

Step 3: Move the locating pin to fix the hex bolt 2 then tighten the hex bolt 1 (with VNM Throttle and VNM Clutch).

Step 4: Reinstall the spring assembly.

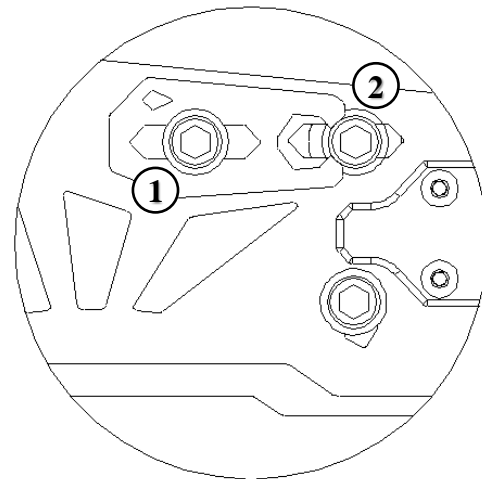

## 5. Exchange Spring & Elastomer

**Step 1: Remove the elastomer stack**

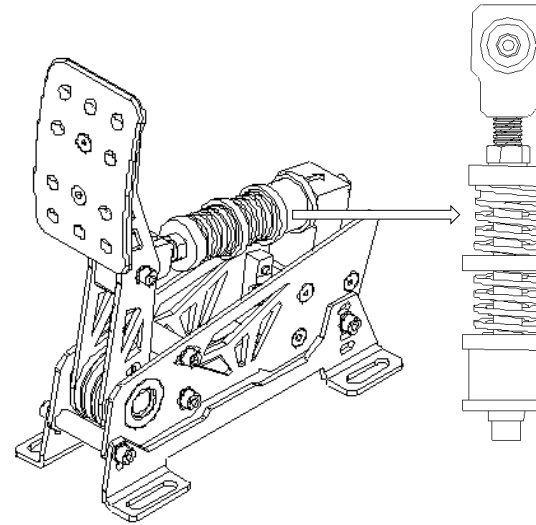

**Step 2: Choose a suitable combination of springs and elastomers**

3 combinations are recommended, but feel free to mix and match to find the perfect combo for you.

Option 1: Red, Blu, Yellow spring + 2 elastomers

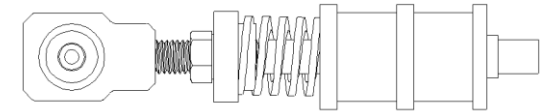

Option 2: Steel spring + 2 elastomers

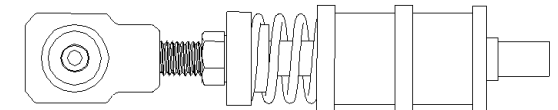

Option 3: 2 springs + 1 elastomer

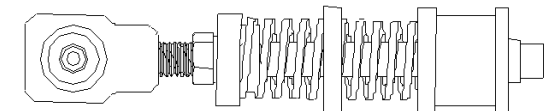

**Step 3: Re-install the elastomer stack**

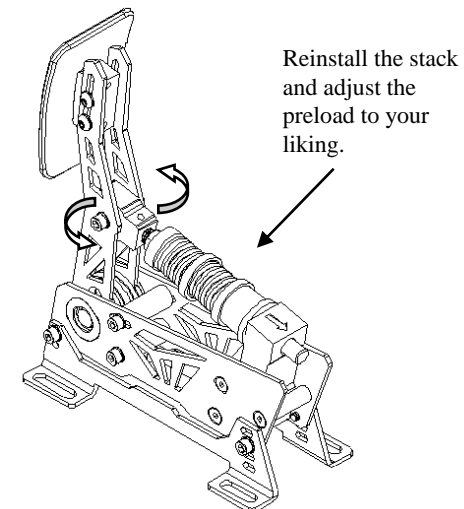

Reinstall the stack  
and adjust the  
preload to your  
liking.

## Mounting Drawing Throttle

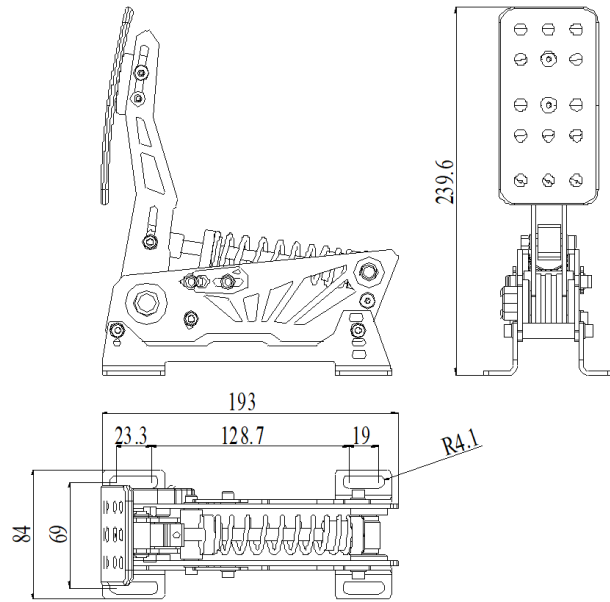

## Mounting Drawing Brake

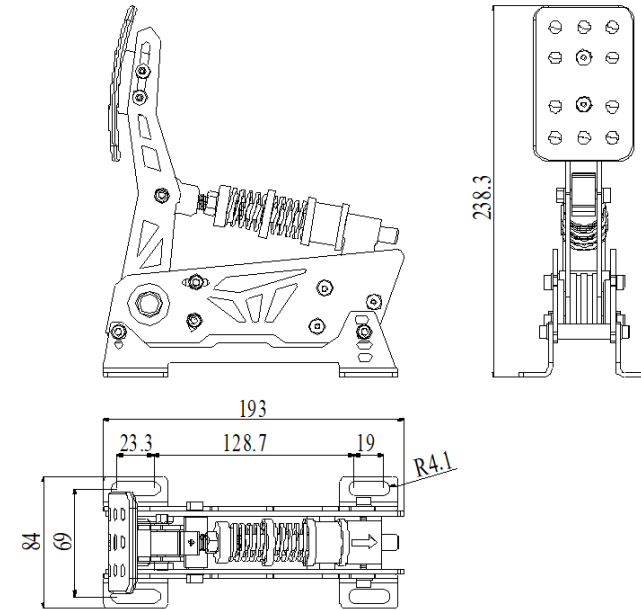

## Mounting Drawing Controller Box

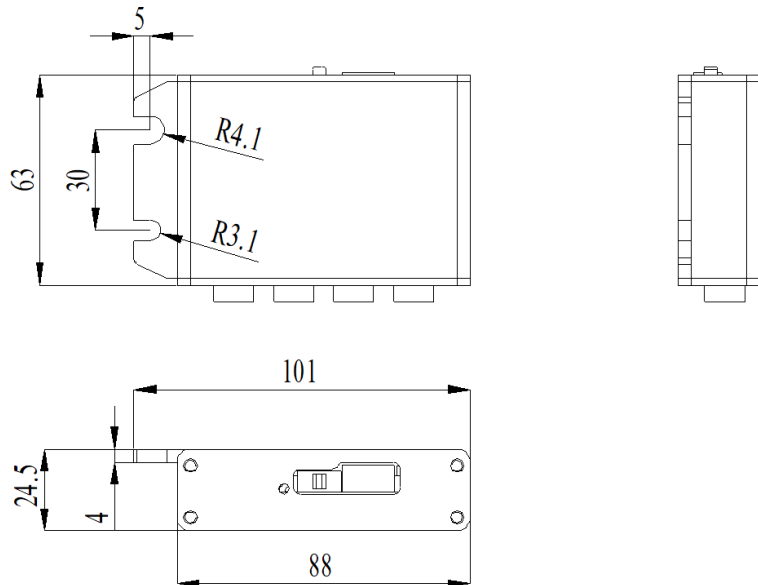

## Mounting Drawing Clutch

